

RTE.	SECTION	COUNTY	TOTAL SHEETS	SHEET NO.
TR 207	23-03138-00-DR	PIATT	2	1

STATE OF ILLINOIS
DEPARTMENT OF TRANSPORTATION
PLANS FOR PROPOSED
LOCAL FUNDING PROJECT
PIATT COUNTY
CERRO GORDO TOWNSHIP SECTION 23-03138-00-DR
TOWNSHIP ROAD 207 OVER UNNAMED STREAM

HIGHWAY STANDARDS (INCLUDED IN PROPOSAL)

- 000001-08 STD. SYMBOLS, ABBREVIATIONS AND PATTERNS
- 701001-02 OFF-RD OPERATIONS, 2L, 2W, MORE THAN 15' (4.5 M) AWAY
- 701006-05 OFF-RD OPERATIONS, 2L, 2W, 15' (4.5 M) TO 24" (600 MM) FROM PAVEMENT EDGE
- 701901-09 TRAFFIC CONTROL DEVICES

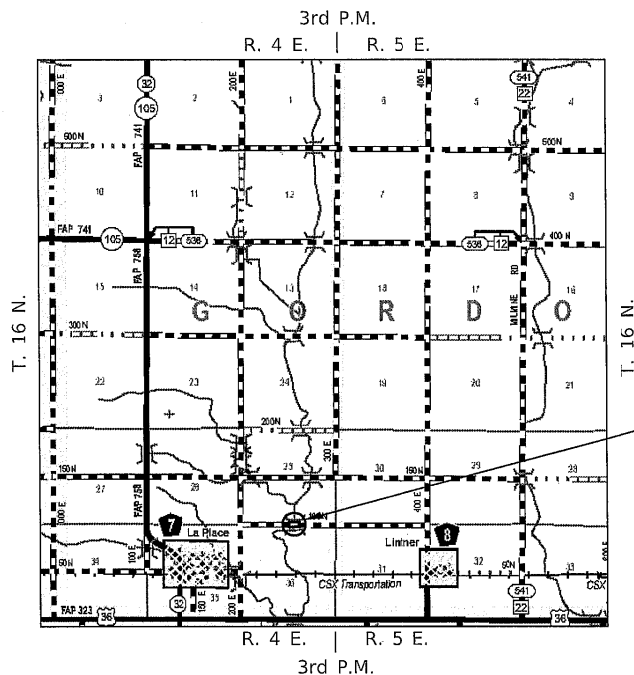
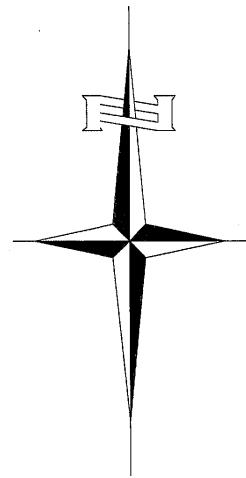
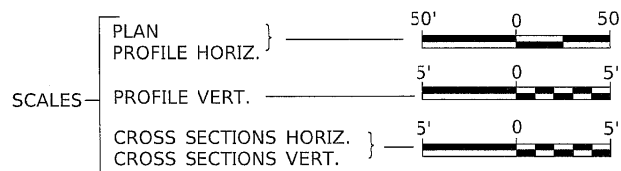

PLACING STONE RIPRAP IN THE IMMEDIATE BRIDGE AREA OF EXISTING TOWNSHIP ROAD 207 OVER UNNAMED STREAM BRIDGE.
S.N. 074-3164

LOCATION MAP

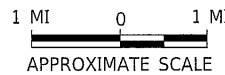

UTILITY COMPANIES

FRONTIER COMMUNICATIONS
BLOOMINGTON, ILLINOIS

COLES-MOULTRIE ELECTRIC COOPERATIVE
MATTOON, ILLINOIS

J.U.L.I.E.
JOINT UTILITY LOCATION INFORMATION FOR EXCAVATION
1-800-892-0123
OR 811

CERRO GORDO TOWNSHIP

INDEX OF SHEETS

- 1 **COVER SHEET**
- 2 **GENERAL PLAN & ELEVATION**

DATE: 3/11/24

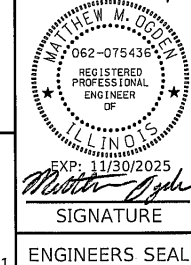

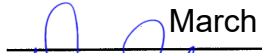
APPROVED  March 18, 2024

CERRO GORDO ROAD DISTRICT
HIGHWAY COMMISSIONER

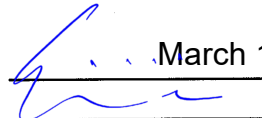
APPROVED  March 18, 2024

PIATT COUNTY ENGINEER



FILE NAME: V:\5109-1 - TR 207 over Unnamed Stream (Platt18 - CADD) - CADD Sheets\5109-01-e001.dgn

B.M.: R.R. Spike in South Side of Support Pole Sta. 18+75, 30' Lt. Elev. 681.20

Cut "□" in Abutment at SE Corner of Bridge Sta. 20+33, 13' Rt. Elev. 684.56

R.R. Spike in North Side of Telephone Pole Sta. 20+89, 25' Lt. Elev. 680.98

Existing Structure:

Three span precast prestressed concrete deck beam superstructure on spill-thru concrete abutments and exposed metal shell pile bent piers. The structure is 69'-0" back to back of abutments, 26'-0" out to out of deck with a 26'-0" drivable width, and is not skewed. The structure was constructed in 1978. Str. No. 074-3164

Salvage: N/A, Structure to Remain.

Roadway to remain open to traffic during construction.

GENERAL NOTES

Layout of the slope protection system may be varied in the field to suit ground conditions as directed by the Engineer.
Stone Riprap, Class A5 has an application rate of 115 lb/cu ft.

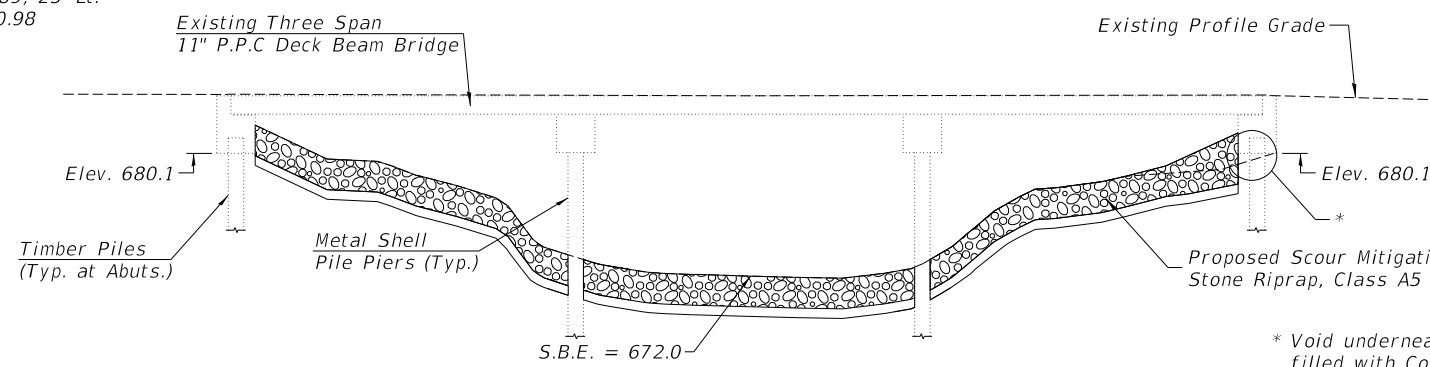

* Void underneath east abutment shall be filled with Controlled Low-Strength Material. See Special Provisions.

ELEVATION

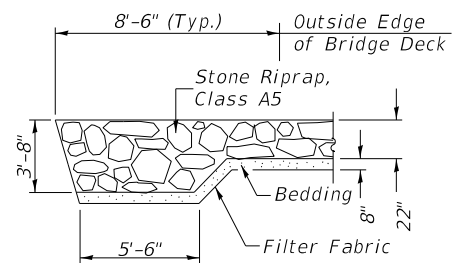

SECTION A-A

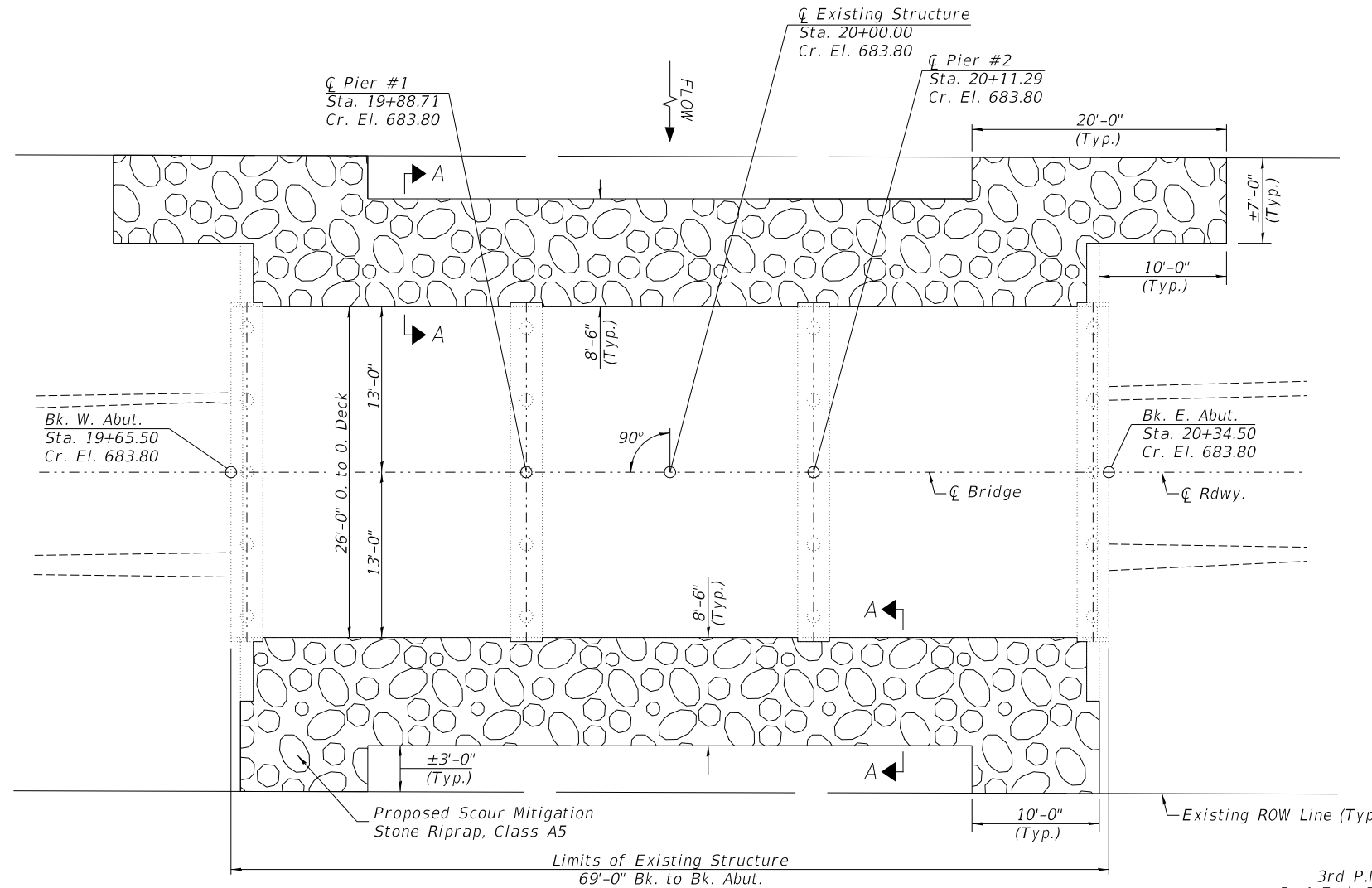

PLAN

TOTAL BILL OF MATERIAL

ITEM	UNIT	TOTAL
Stone Riprap, Class A5	TON	465
Filter Fabric	SQ YD	360
Controlled Low-Strength Material	CU YD	1.1
Traffic Control and Protection, (Special)	L SUM	1

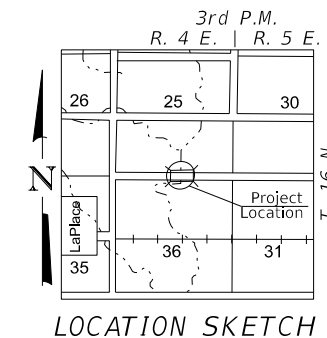

LOCATION SKETCH

**GENERAL PLAN & ELEVATION
TOWNSHIP ROAD 207
OVER UNNAMED STREAM
SECTION 23-03138-00-DR
PIATT COUNTY
STATION 20+00.00
STRUCTURE NO. 074-3164**

MODEL: \\MOBILE\NAME\FILE: \\NAME: 23-03138-00-DR - TR 207 over Unnamed Stream (R18)118 - CADD2 - CADD Sheets\109-1-0001.dgn

USER NAME = MOgden	DESIGNED - CRN	REVISED - _____
	DRAWN - CRN	REVISED - _____
PLOT SCALE = 100,000' / in.	CHECKED - MMO/BAN	REVISED - _____
PLOT DATE = 3/11/2024	DATE - 3/11/2024	REVISED - _____

**PIATT COUNTY
TOWNSHIP ROAD 207 OVER
UNNAMED STREAM**

GENERAL PLAN & ELEVATION

SCALE: NONE SHEET 1 OF 1 SHEETS

RT#	SECTION	COUNTY	TOTAL SHEETS	SHEET NO.
TR 207	23-03138-00-DR	PIATT	2	2
SN 074-3164				
ILLINOIS				